

CONTRA II LED

GENERAL CARD

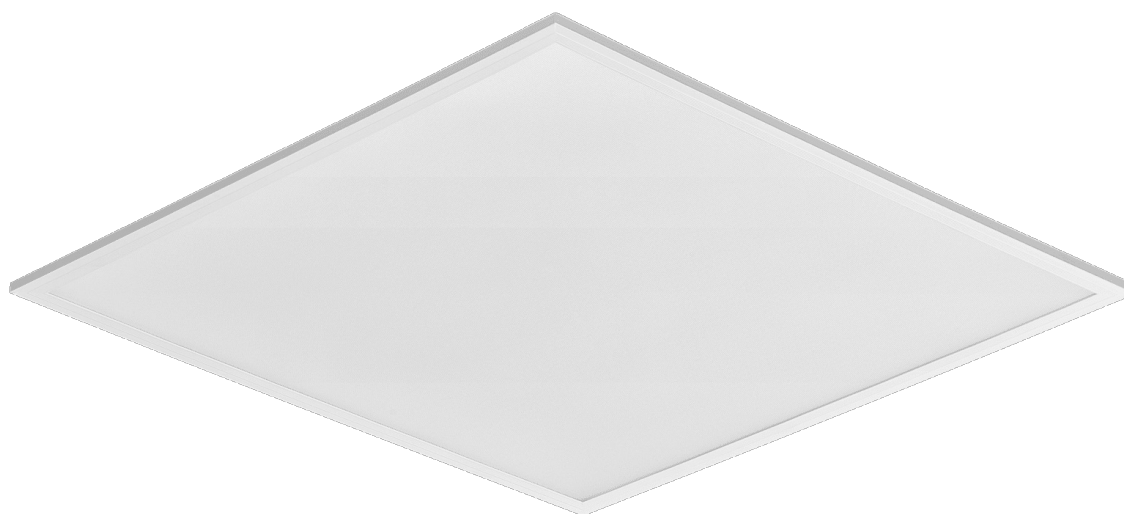

TECHNICAL PARAMETERS

Ingress protection:	IP40/IP20
Rated power of the luminaire [W]*:	24.00 - 36.00
Luminous flux [lm]*:	3500 - 5850
Luminous efficacy [lm/W]:	145.00 - 163.00
Color rendering index (Ra) >:	80
SDCM:	3
Energy efficiency class:	B; C
Material of the body:	coated steel
Diffuser material:	PS
Diffuser type:	PRM; matt
Mounting version:	podtynkowy, natynkowy, zwieszany
Dimensions (H/W/T/S) [mm]:	1195/295/30; 595/595/30;

CHARACTERISTICS

Contra II LED versatile LED panel characterised by its low, slim profile and elegant design. Adapted for flush-mounted installation in modular ceilings, surface-mounted or suspended using an additional frame (available as an accessory). Luminaire with integrated energy-saving LED module, made of white painted aluminium profile, equipped with structured multi-layer PS MAT or PRM shade for perfect light diffusion. Contra II LED is a new version of the proven series of LED cassette panels, designed for maximum energy efficiency, user comfort and modern commercial and office spaces. The use of a new, high-efficiency LED module with a luminous efficacy of 145–163 lm/W significantly reduces energy consumption while maintaining high light quality. Contra II LED is ideally suited to the requirements of modern investments where energy efficiency, durability and compliance with current lighting standards are of key importance.

APPLICATION

The luminaire is intended for indoor use in office (offices, conference rooms) or representative use (hotels, restaurants); illumination of public facilities, including hospitals, educational facilities, offices, halls, garages, passageways, warehouses, shops, as well as in the food industry and food-related retail and service facilities. The unique design and excellent light performance enable CONTRA LED to be used as the main source of light, also for work that requires visual focus. The lamp is suitable for both new applications and the replacement of traditional T8 and T5 luminaires with energy-efficient LED solutions.

CONTRA II LED

GENERAL CARD

AVAILABLE VERSIONS



Click index >>, to see details

CONTRA II LED 1195/295/30mm

Rated power of the luminaire [W]*	Colour temperature [K]	Luminous flux [lm]*	Luminous efficacy [lm/W]	Diffuser type	Beam angle [°]	Dimensions (H/W/T/S) [mm]	Index
24	4000	3500	146	matt	110	1195/295/30	>> 375804
24	4000	3900	163	PRM	115	1195/295/30	>> 379758
31	4000	4500	145	matt	110	1195/295/30	>> 375811
31	4000	5050	163	PRM	115	1195/295/30	>> 375989

CONTRA II LED 595/595/30mm

Rated power of the luminaire [W]*	Colour temperature [K]	Luminous flux [lm]*	Luminous efficacy [lm/W]	Diffuser type	Beam angle [°]	Dimensions (H/W/T/S) [mm]	Index
24	4000	3500	146	matt	110	595/595/30	>> 375842
24	4000	3900	163	PRM	115	595/595/30	>> 375873
31	4000	4500	145	matt	110	595/595/30	>> 375859
31	4000	5050	163	PRM	115	595/595/30	>> 375866
36	4000	5250	146	matt	110	595/595/30	>> 375996
36	4000	5850	163	PRM	115	595/595/30	>> 375880

CONTRA II LED

GENERAL CARD

ACCESSORIES AVAILABLE

index	Name
999543	Plasterboard recessing kit 630x630 white (steel version)
374708	CONTRA LED surface-mounted frame CLICK 1200x300x65mm
998966	Frame steel white structure RAL9016 600x600 SM "well effect"
374845	Frame adapter KG 635x635 WHITE
374715	CONTRA LED surface-mounted frame CLICK 600x600x65mm
374852	Frame adapter KG 1235x335 WHITE
374692	CONTRA LED suspension system 1200x300
374739	CONTRA LED - suspension system 1200x300 DALI
374685	CONTRA LED suspension system 600x600
374722	CONTRA LED suspension system 600x600 DALI
374838	CONTRA LED MOUNTING CLIPS IN KG (4PCS)
761294	Emergency module 2W/10-50V Li-ION EMG-A-Li-2L 3h 3.6V 2.5Ah AT - CONTRA (GKO)
374708/próbka handlowa	CONTRA LED surface-mounted frame CLICK 1200x300x65mm

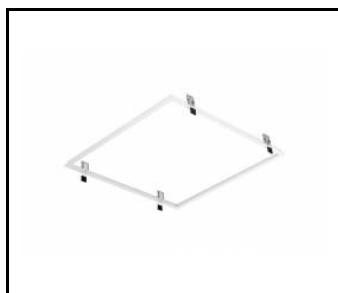

Plasterboard recessing kit 630x630 white (steel version) (999543)

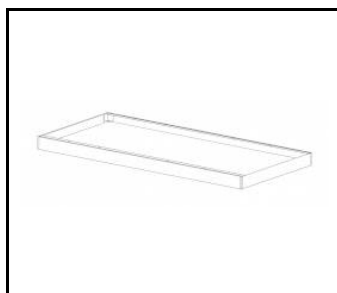

CONTRA LED surface-mounted frame CLICK 1200x300x65mm (374708)



Frame steel white structure RAL9016 600x600 SM "well effect" (998966)

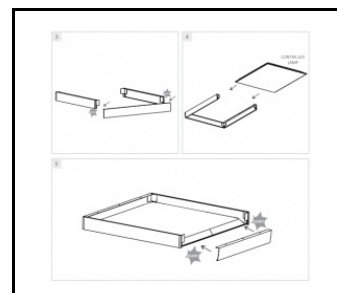

CONTRA LED surface-mounted frame CLICK 600x600x65mm (374715)



CONTRA LED suspension system 1200x300 (374692)



CONTRA LED suspension system 600x600 (374685)

Card creation date: 26 March 2026

The company reserves the right to make design changes or upgrades in the presented product. Product data sheet does not constitute an offer. * Parameter tolerance is +/- 10%



This product is a subject to electric and electronic waste equipment regulations (WEEE).



Certificate CE - Nr: 06/2026