

QUEST LED EVO EVEREST

GENERAL CARD



TECHNICAL PARAMETERS

Ingress protection:	IP66
Impact resistance:	IK08; IK10
Rated power of the luminaire [W]*:	104.00 - 310.00
Luminous flux [lm]*:	13800 - 50900
Colour temperature [K]:	3000; 4000; 5000; 5700; 6500
Color rendering index (Ra) >:	70; 80; 90
SDCM:	3
Electrical protection class:	I
Energy efficiency class:	A; B; C; D
Material of the body:	aluminium
Diffuser material:	glass
Diffuser type:	transparent
Beam angle [°]:	30; 55; 75; 85; 120
Mounting version:	suspended
Dimensions (H/W/T/S) [mm]:	570/441/87;
Warranty [years]:	5

CHARACTERISTICS

The Quest LED Evo Everest is the pinnacle of technology in the field of high-bay luminaires. The latest, largest and most powerful member of the renowned and proven QUEST family, designed for the most demanding production, logistics and warehouse spaces. It combines exceptional light efficiency, uncompromising durability and an aesthetic, industrial design. It is a modern, premium-class industrial luminaire, manufactured in Poland, designed for use in demanding environments thanks to its die-cast aluminium body, without an external heat sink and fins that make it difficult to keep clean, while perfectly dissipating excess heat. The diffuser is made of tempered glass, under which are high-performance LEDs. Various types of optics, especially asymmetrical ones, provide great freedom in selecting the right solution for a specific application. Thanks to the highest tightness rating on the market (IP66) and maximum impact resistance (IK10), EVEREST will perform well in all conditions – regardless of the weather and installation location, with an efficiency of 170 lm/W. An additional advantage for contractors is the sealed quick connector – an innovative solution that eliminates traditional, time-consuming connection methods. Thanks to an intuitive system of coloured latches, connecting the lamp is simple, quick and tool-free. A set of accessories allows you to expand the lamp with an additional module or modules, significantly increasing its lighting capabilities, which is particularly important for high halls. Models available with Zhaga D4i module.

APPLICATION

Quest LED Evo Everest is widely used in lighting educational, administrative and institutional facilities, halls, garages, passageways, warehouses, shops, as well as in the food industry and commercial and service facilities related to food products. They can be used as a solution for sports fields, open spaces and car parks.

QUEST LED EVO EVEREST

GENERAL CARD

AVAILABLE VERSIONS



Click index >>, to see details

QUEST LED EVO EVEREST 120°

Rated power of the luminaire [W]*	Colour temperature [K]	Luminous flux [lm]*	Color rendering index (Ra) >	Beam angle [°]	Light distribution type	DIMM DALI	Socket type	Index
104	4000	19400	70	120				>> 830006
104	4000	19400	70	120		yes		>> 830044
104	5700	17500	70	120				>> 830082
104	5700	17500	70	120		yes		>> 830129
150	4000	27400	70	120				>> 830013
150	4000	27400	70	120		yes		>> 830051
150	5700	24700	70	120				>> 830099
150	5700	24700	70	120		yes		>> 830136
203	4000	36000	70	120				>> 830020
203	4000	36000	70	120		yes		>> 830068
203	5700	32500	70	120				>> 830105
203	5700	32500	70	120		yes		>> 830143
256	4000	43300	70	120				>> 830037
256	4000	43300	70	120		yes		>> 830075
256	5700	39100	70	120				>> 830112
256	5700	39100	70	120		yes		>> 830150
310	4000	50900	70	120				>> 831621
310	5700	46000	70	120				>> 831638
104	3000	17300	80	120				>> 830167
104	3000	17300	80	120		yes		>> 830204
104	4000	18100	80	120				>> 830242
104	4000	18100	80	120		yes		>> 830280
104	5000	16200	80	120				>> 830327
104	5000	16200	80	120		yes		>> 830365
104	5700	18000	80	120				>> 830402
104	5700	18000	80	120		yes		>> 830440
104	6500	17700	80	120				>> 830488
104	6500	17700	80	120		yes		>> 830525
150	3000	24500	80	120				>> 830174
150	3000	24500	80	120		yes		>> 830211
150	4000	25700	80	120				>> 830259
150	4000	25700	80	120		yes		>> 830297
150	5000	22900	80	120				>> 830334

QUEST LED EVO EVEREST

GENERAL CARD

Rated power of the luminaire [W]*	Colour temperature [K]	Luminous flux [lm]*	Color rendering index (Ra) >	Beam angle [°]	Light distribution type	DIMM DALI	Socket type	Index
150	5000	22900	80	120		yes		>> 830372
150	5700	25400	80	120				>> 830419
150	5700	25400	80	120		yes		>> 830457
150	6500	25000	80	120				>> 830495
150	6500	25000	80	120		yes		>> 830532
203	3000	32200	80	120				>> 830181
203	3000	32200	80	120		yes		>> 830228
203	4000	33700	80	120				>> 830266
203	4000	33700	80	120		yes		>> 830303
203	5000	30100	80	120				>> 830341
203	5000	30100	80	120		yes		>> 830389
203	5700	33400	80	120				>> 830426
203	5700	33400	80	120		yes		>> 830464
203	6500	33000	80	120				>> 830501
203	6500	33000	80	120		yes		>> 830549
256	3000	38700	80	120				>> 830198
256	3000	38700	80	120		yes		>> 830235
256	4000	40600	80	120				>> 830273
256	4000	40600	80	120		yes		>> 830310
256	5000	36300	80	120				>> 830358
256	5000	36300	80	120		yes		>> 830396
256	5700	40200	80	120				>> 830433
256	5700	40200	80	120		yes		>> 830471
256	6500	39600	80	120				>> 830518
256	6500	39600	80	120		yes		>> 830556
310	3000	45500	80	120				>> 831645
310	4000	47600	80	120				>> 831652
310	5000	42600	80	120				>> 831669
310	5700	47200	80	120				>> 831676
310	6500	46500	80	120				>> 831683
104	4000	14600	90	120				>> 830563
104	4000	14600	90	120		yes		>> 830600
104	5700	14400	90	120				>> 830648
104	5700	14400	90	120		yes		>> 830686
150	4000	20600	90	120				>> 830570
150	4000	20600	90	120		yes		>> 830617
150	5700	20400	90	120				>> 830655
150	5700	20400	90	120		yes		>> 830693

QUEST LED EVO EVEREST

GENERAL CARD

Rated power of the luminaire [W]*	Colour temperature [K]	Luminous flux [lm]*	Color rendering index (Ra) >	Beam angle [°]	Light distribution type	DIMM DALI	Socket type	Index
203	4000	27000	90	120				>> 830587
203	4000	27000	90	120		yes		>> 830624
203	5700	26800	90	120				>> 830662
203	5700	26800	90	120		yes		>> 830709
256	4000	32600	90	120				>> 830594
256	4000	32600	90	120		yes		>> 830631
256	5700	32300	90	120				>> 830679
256	5700	32300	90	120		yes		>> 830716
310	4000	38200	90	120				>> 831690
310	5700	37900	90	120				>> 831706

QUEST LED EVO EVEREST 30°

Rated power of the luminaire [W]*	Colour temperature [K]	Luminous flux [lm]*	Color rendering index (Ra) >	Beam angle [°]	Light distribution type	DIMM DALI	Socket type	Index
310	4000	48600	70	30				>> 831447
310	5700	43950	70	30				>> 831461
310	3000	43450	80	30				>> 831485
310	4000	45450	80	30				>> 831508
310	5000	40700	80	30				>> 831522
310	5700	45100	80	30				>> 831546
310	6500	44400	80	30				>> 831560
310	4000	36500	90	30				>> 831584
310	5700	36200	90	30				>> 831607

QUEST LED EVO EVEREST 33 x 68°

Rated power of the luminaire [W]*	Colour temperature [K]	Luminous flux [lm]*	Color rendering index (Ra) >	Beam angle [°]	Light distribution type	DIMM DALI	Socket type	Index
104	4000	17100	80	33 x 68	CN	yes		>> 792380
104	4000	17100	80	33 x 68	CN			>> 792342
150	4000	24300	80	33 x 68	CN	yes		>> 792397
150	4000	24300	80	33 x 68	CN			>> 792359
203	4000	31850	80	33 x 68	CN	yes		>> 792403
203	4000	31850	80	33 x 68	CN			>> 792366
256	4000	38350	80	33 x 68	CN	yes		>> 792410
256	4000	38350	80	33 x 68	CN			>> 792373
310	4000	45000	80	33 x 68	CN			>> 792427

QUEST LED EVO EVEREST 55°

Rated power of the luminaire [W]*	Colour temperature [K]	Luminous flux [lm]*	Color rendering index (Ra) >	Beam angle [°]	Light distribution type	DIMM DALI	Socket type	Index
104	4000	17100	80	55	SN	yes		>> 792212

QUEST LED EVO EVEREST

GENERAL CARD

Rated power of the luminaire [W]*	Colour temperature [K]	Luminous flux [lm]*	Color rendering index (Ra) >	Beam angle [°]	Light distribution type	DIMM DALI	Socket type	Index
104	4000	17100	80	55	SN			>> 792175
150	4000	24300	80	55	SN	yes		>> 792229
150	4000	24300	80	55	SN			>> 792182
203	4000	31850	80	55	SN	yes		>> 792236
203	4000	31850	80	55	SN			>> 792199
256	4000	38350	80	55	SN	yes		>> 792243
256	4000	38350	80	55	SN			>> 792205
310	4000	45000	80	55	SN			>> 792250

QUEST LED EVO EVEREST 75°

Rated power of the luminaire [W]*	Colour temperature [K]	Luminous flux [lm]*	Color rendering index (Ra) >	Beam angle [°]	Light distribution type	DIMM DALI	Socket type	Index
104	4000	18500	70	75				>> 830723
104	4000	18500	70	75		yes		>> 830761
104	5700	16700	70	75				>> 830808
104	5700	16700	70	75		yes		>> 830846
150	4000	26100	70	75				>> 830730
150	4000	26100	70	75		yes		>> 830778
150	5700	24600	70	75				>> 830815
150	5700	24600	70	75		yes		>> 830853
203	4000	34400	70	75				>> 830747
203	4000	34400	70	75		yes		>> 830785
203	5700	31000	70	75				>> 830822
203	5700	31000	70	75		yes		>> 830860
256	4000	41400	70	75				>> 830754
256	4000	41400	70	75		yes		>> 830792
256	5700	37300	70	75				>> 830839
256	5700	37300	70	75		yes		>> 830877
310	4000	48600	70	75				>> 831805
310	5700	43950	70	75				>> 831812
104	3000	16500	80	75				>> 830884
104	3000	16500	80	75		yes		>> 830921
104	4000	17300	80	75				>> 830969
104	4000	17300	80	75		yes		>> 831003
104	4000	17300	80	75	SW	yes	ZG-DN	>> 881916
104	5000	15500	80	75				>> 831041
104	5000	15500	80	75		yes		>> 831089
104	5700	17200	80	75				>> 831126
104	5700	17200	80	75		yes		>> 831164

QUEST LED EVO EVEREST

GENERAL CARD

Rated power of the luminaire [W]*	Colour temperature [K]	Luminous flux [lm]*	Color rendering index (Ra) >	Beam angle [°]	Light distribution type	DIMM DALI	Socket type	Index
104	6500	17000	80	75				>> 831201
104	6500	17000	80	75		yes		>> 831249
150	3000	23400	80	75				>> 830891
150	3000	23400	80	75		yes		>> 830938
150	4000	24500	80	75				>> 830976
150	4000	24500	80	75		yes		>> 831010
150	5000	21900	80	75				>> 831058
150	5000	21900	80	75		yes		>> 831096
150	5700	24300	80	75				>> 831133
150	5700	24300	80	75		yes		>> 831171
150	6500	23900	80	75				>> 831218
150	6500	23900	80	75		yes		>> 831256
173	4000	28500	80	75	SW	yes	ZG-DN	>> 792595
203	3000	30700	80	75				>> 830907
203	3000	30700	80	75		yes		>> 830945
203	4000	32200	80	75				>> 830983
203	4000	32200	80	75		yes		>> 831027
203	5000	28700	80	75				>> 831065
203	5000	28700	80	75		yes		>> 831102
203	5700	31900	80	75				>> 831140
203	5700	31900	80	75		yes		>> 831188
203	6500	31500	80	75				>> 831225
203	6500	31500	80	75		yes		>> 831263
256	3000	37000	80	75				>> 830914
256	3000	37000	80	75		yes		>> 830952
256	4000	38800	80	75				>> 830990
256	4000	38800	80	75		yes		>> 831034
256	5000	34700	80	75				>> 831072
256	5000	34700	80	75		yes		>> 831119
256	5700	38400	80	75				>> 831157
256	5700	38400	80	75		yes		>> 831195
256	6500	37800	80	75				>> 831232
256	6500	37800	80	75		yes		>> 831270
310	3000	43450	80	75				>> 831829
310	4000	45450	80	75				>> 831836
310	5000	40700	80	75				>> 831843
310	5700	45100	80	75				>> 831850
310	6500	44400	80	75				>> 831867

QUEST LED EVO EVEREST

GENERAL CARD

Rated power of the luminaire [W]*	Colour temperature [K]	Luminous flux [lm]*	Color rendering index (Ra) >	Beam angle [°]	Light distribution type	DIMM DALI	Socket type	Index
104	4000	13900	90	75				>> 831287
104	4000	13900	90	75		yes		>> 831324
104	5700	13800	90	75				>> 831362
104	5700	13800	90	75		yes		>> 831409
150	4000	19700	90	75				>> 831294
150	4000	19700	90	75		yes		>> 831331
150	5700	19500	90	75				>> 831379
150	5700	19500	90	75		yes		>> 831416
203	4000	25800	90	75				>> 831300
203	4000	25800	90	75		yes		>> 831348
203	5700	25600	90	75				>> 831386
203	5700	25600	90	75		yes		>> 831423
256	4000	31100	90	75				>> 831317
256	4000	31100	90	75		yes		>> 831355
256	5700	30800	90	75				>> 831393
256	5700	30800	90	75		yes		>> 831430
310	4000	36500	90	75				>> 831874
310	5700	36200	90	75				>> 831881

QUEST LED EVO EVEREST 85°

Rated power of the luminaire [W]*	Colour temperature [K]	Luminous flux [lm]*	Color rendering index (Ra) >	Beam angle [°]	Light distribution type	DIMM DALI	Socket type	Index
104	4000	17100	80	85	MW	yes		>> 792045
104	4000	17100	80	85	MW			>> 792007
104	4000	17100	80	85	MW	yes	ZG-DN	>> 881923
150	4000	24300	80	85	MW	yes		>> 792052
150	4000	24300	80	85	MW			>> 792014
173	4000	28250	80	85	MW	yes	ZG-DN	>> 881909
203	4000	31850	80	85	MW	yes		>> 792069
203	4000	31850	80	85	MW			>> 792021
256	4000	38350	80	85	MW	yes		>> 792076
256	4000	38350	80	85	MW			>> 792038
310	4000	45000	80	85	MW			>> 792083

QUEST LED EVO EVEREST

GENERAL CARD

ACCESSORIES AVAILABLE

index	Name
831737	QUEST EVO EVEREST recessed frame RAL7016
831720	QUEST EVO EVEREST protective grid RAL9003
831713	QUEST EVO EVEREST protective grid RAL7016
831768	QUEST EVO EVEREST luminaire connector - separate suspension RAL7016
831751	QUEST EVO EVEREST luminaire connector - common suspension RAL7016
831744	QUEST EVO EVEREST holder NT RAL7016
831782	QUEST EVO EVEREST holder AW RAL7016
831775	QUEST EVO EVEREST holder RCR RAL7016

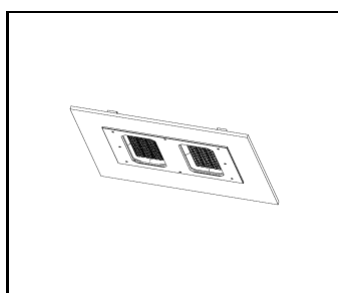

QUEST EVO EVEREST recessed frame RAL7016 (831737)

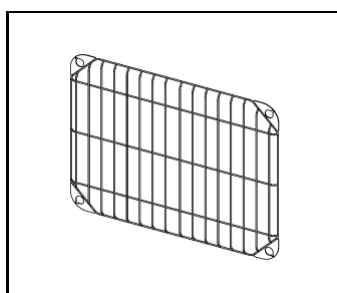

QUEST EVO EVEREST protective grid RAL9003 (831720)

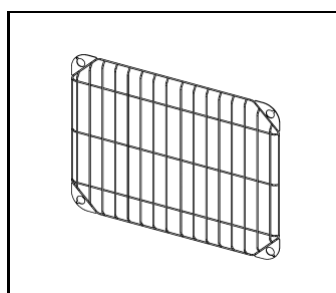

QUEST EVO EVEREST protective grid RAL7016 (831713)

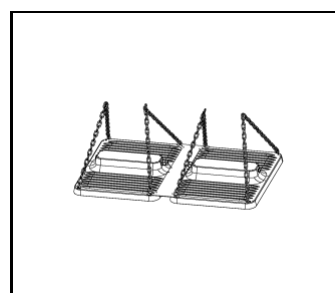

QUEST EVO EVEREST luminaire connector - separate suspension RAL7016 (831768)

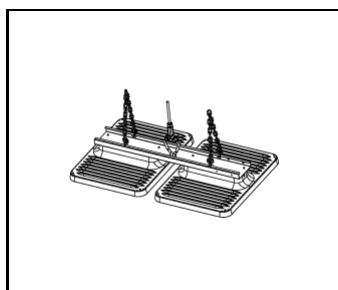

QUEST EVO EVEREST luminaire connector - common suspension RAL7016 (831751)

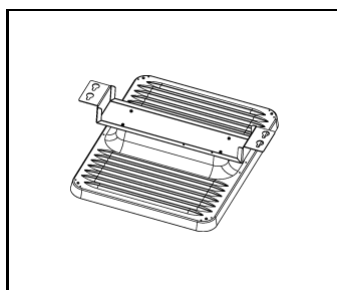

QUEST EVO EVEREST holder NT RAL7016 (831744)

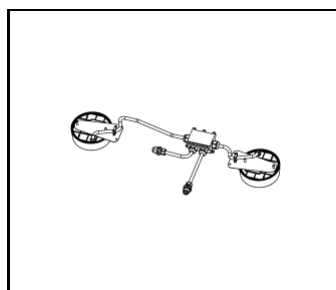

QUEST EVO EVEREST holder AW RAL7016 (831782)

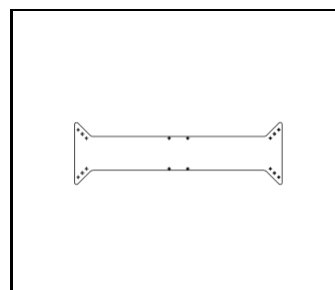

QUEST EVO EVEREST holder RCR RAL7016 (831775)

Card creation date: 30 April 2026

The company reserves the right to make design changes or upgrades in the presented product. Product data sheet does not constitute an offer. * Parameter tolerance is +/- 10%

 This product is a subject to electric and electronic waste equipment regulations (WEEE).

 Certificate CE - Nr: 98/2025