

# ILUMI GROUND

GENERAL CARD



## TECHNICAL PARAMETERS

<b>Rated power of the luminaire [W]*:</b>	17.00; 30.00
<b>Colour temperature [K]:</b>	3000; 4000
<b>Luminous flux [lm]*:</b>	1390 - 3550
<b>Ingress protection:</b>	IP67
<b>Impact resistance:</b>	IK10
<b>Color rendering index (Ra) &gt;:</b>	80
<b>Material of the body:</b>	aluminium
<b>Colour of the body:</b>	silver
<b>Beam angle [°]:</b>	10; 30
<b>Working temperature [°C]:</b>	from -20 to +55
<b>Dimensions (H/W/T/S) [mm]:</b>	f148; f216.5;

## CHARACTERISTICS

The Ilumi Ground series was designed for the most demanding customers looking for customised and economical solutions. The body of the luminaire is made of cast aluminium, which has enabled a significant reduction in weight and price. A mounting box is included.

## APPLICATION

The luminaires are ideal for illuminating garden or park spaces. Due to their lightweight construction, they are easy to install on external walls. The Ilumi Ground luminaire can be used to illuminate a wide range of spaces and objects, such as parks, gardens, terraces, squares, premises and plants.

# ILUMI GROUND

GENERAL CARD

## AVAILABLE VERSIONS



Click index >>, to see details

Rated power of the luminaire [W]*	Colour temperature [K]	Luminous flux [lm]*	Version	Beam angle [°]	Dimensions (H/W/T/S) [mm]	Index
17	3000	1390	S	10	fi148	<a href="#">&gt;&gt; 377228</a>
17	3000	1390	S	30	fi148	<a href="#">&gt;&gt; 377235</a>
17	4000	1450	S	10	fi148	<a href="#">&gt;&gt; 377242</a>
17	4000	1450	S	30	fi148	<a href="#">&gt;&gt; 377259</a>
30	3000	3200	M	10	fi216.5	<a href="#">&gt;&gt; 377266</a>
30	3000	3200	M	30	fi216.5	<a href="#">&gt;&gt; 377273</a>
30	4000	3550	M	10	fi216.5	<a href="#">&gt;&gt; 377280</a>
30	4000	3550	M	30	fi216.5	<a href="#">&gt;&gt; 377297</a>

# ILUMI GROUND

GENERAL CARD

## LUMINOUS INTENSITY DISTRIB. CURVE

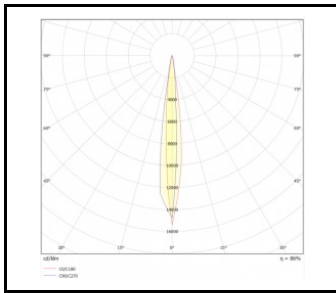

10°

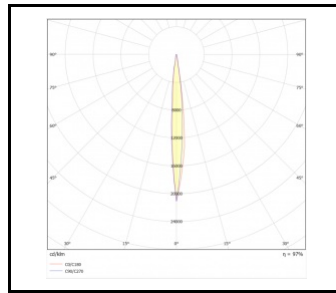

10°

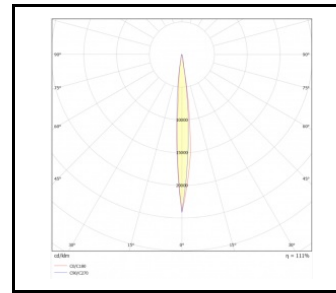

10°

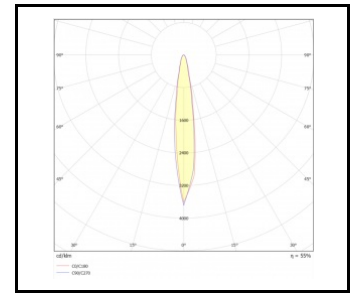

10°

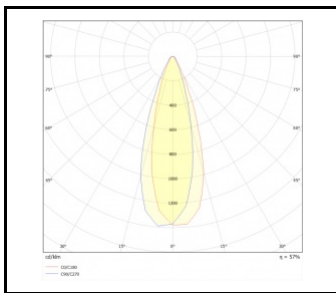

30°

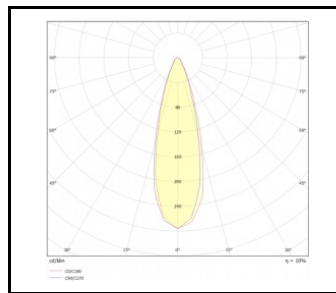

30°

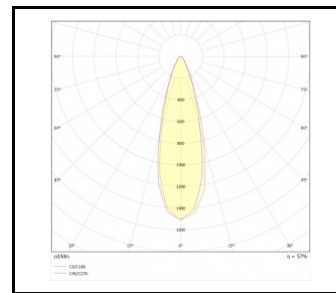

30°

# ILUMI GROUND

## GENERAL CARD

### Ilumi Ground XS

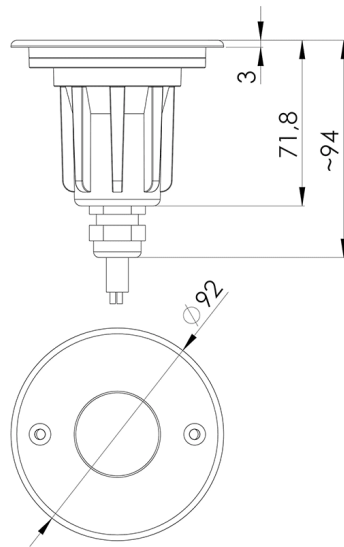

### Ilumi Ground S

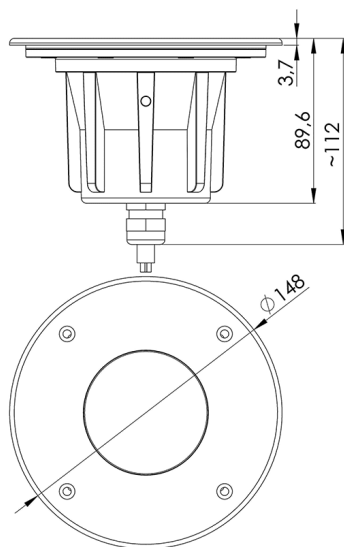

Card creation date: 29 October 2025

The company reserves the right to make design changes or upgrades in the presented product. Product data sheet does not constitute an offer. \* Parameter tolerance is +/- 10%



This product is a subject to electric and electronic waste equipment regulations (WEEE).



Certificate CE - Nr: 55/2025

Ilumi Ground M

