

# CONTRA LED

GENERAL CARD

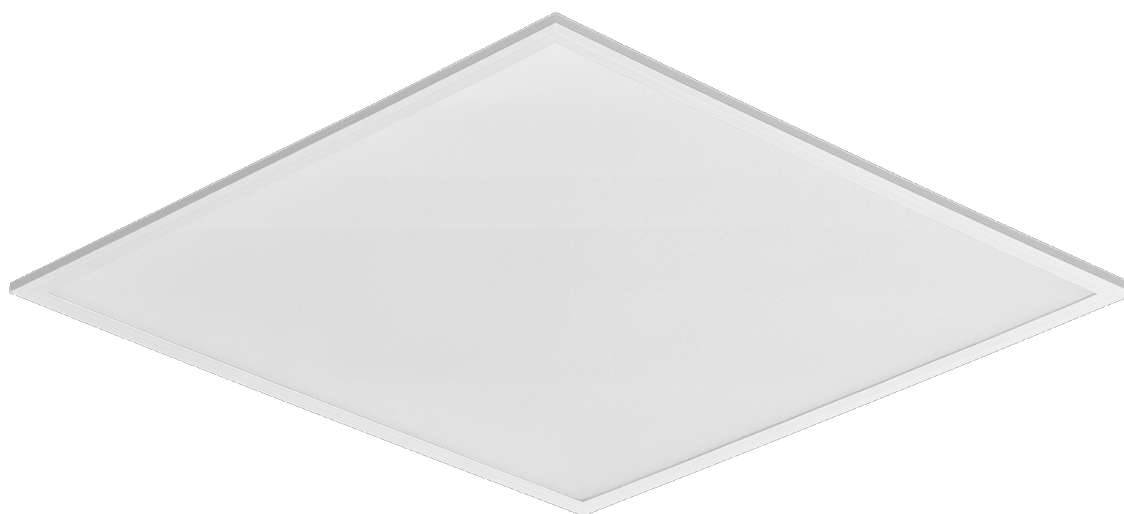

## TECHNICAL PARAMETERS

<b>Ingress protection:</b>	IP40/IP20; IP44/IP20
<b>Impact resistance:</b>	IK06
<b>Rated power of the luminaire [W]*:</b>	24.00; 31.00; 36.00
<b>Luminous flux [lm]*:</b>	3200; 4300; 4500; 5000
<b>Colour temperature [K]:</b>	4000
<b>Colour rendering index:</b>	>80
<b>Electrical protection class:</b>	II
<b>Material of the body:</b>	coated aluminium
<b>Diffuser type:</b>	MAT; PRM
<b>Mounting version:</b>	podtynkowy, natynkowy, zwieszany; recessed, surface, suspended
<b>Dimensions (H/W/T/S) [mm]:</b>	595/595/30; 1195/295/30;
<b>SDCM:</b>	≤ 2

## CHARACTERISTICS

Contra LED versatile LED panel characterised by its low, slim profile and elegant design. Adapted for flush-mounted installation in modular ceilings, surface-mounted or suspended using an additional frame (available as an accessory). Luminaire with integrated energy-saving LED module, made of white painted aluminium profile, equipped with structured multi-layer PS MAT or PRM shade for perfect light diffusion.

## APPLICATION

The luminaire is intended for indoor use in office (offices, conference rooms) or representative use (hotels, restaurants); illumination of public facilities, including hospitals, educational facilities, offices, halls, garages, passageways, warehouses, shops, as well as in the food industry and food-related retail and service facilities. The unique design and excellent light performance enable CONTRA LED to be used as the main source of light, also for work that requires visual focus. The lamp is suitable for both new applications and the replacement of traditional T8 and T5 luminaires with energy-efficient LED solutions.

# CONTRA LED

GENERAL CARD

## AVAILABLE VERSIONS



Click index >>, to see details

### CONTRA LED IP40/IP20

Rated power of the luminaire [W]*	Luminous flux [lm]*	Diffuser type	UGR (4H8H)	DIMM DALI	Beam angle [°]	Dimensions (H/W/T/S) [mm]	Index
24	3200	MAT			110	595/595/30	<a href="#">&gt;&gt; 374517</a>
24	3200	MAT			110	1195/295/30	<a href="#">&gt;&gt; 374548</a>
24	3200	MAT		yes	110	595/595/30	<a href="#">&gt;&gt; 374579</a>
24	3200	MAT		yes	110	1195/295/30	<a href="#">&gt;&gt; 374609</a>
31	4300	MAT			110	595/595/30	<a href="#">&gt;&gt; 374500</a>
31	4300	MAT			110	1195/295/30	<a href="#">&gt;&gt; 374555</a>
31	4300	MAT		yes	110	595/595/30	<a href="#">&gt;&gt; 374562</a>
31	4300	MAT		yes	110	1195/295/30	<a href="#">&gt;&gt; 374616</a>
31	4500	PRM	<19		115	595/595/30	<a href="#">&gt;&gt; 374524</a>
31	4500	PRM	<19	yes	115	595/595/30	<a href="#">&gt;&gt; 374586</a>
36	5000	MAT			110	595/595/30	<a href="#">&gt;&gt; 374531</a>
36	5000	MAT		yes	110	595/595/30	<a href="#">&gt;&gt; 374593</a>

### CONTRA LED IP44/IP20

Rated power of the luminaire [W]*	Luminous flux [lm]*	Diffuser type	UGR (4H8H)	DIMM DALI	Beam angle [°]	Dimensions (H/W/T/S) [mm]	Index
24	3200	MAT			110	1195/295/30	<a href="#">&gt;&gt; 375378</a>
24	3200	MAT		yes	110	1195/295/30	<a href="#">&gt;&gt; 375385</a>
24	3200	MAT			110	595/595/30	<a href="#">&gt;&gt; 375453</a>
24	3200	MAT		yes	110	595/595/30	<a href="#">&gt;&gt; 375460</a>
31	4300	MAT			110	1195/295/30	<a href="#">&gt;&gt; 375392</a>
31	4300	MAT		yes	110	1195/295/30	<a href="#">&gt;&gt; 375446</a>
31	4300	MAT			110	595/595/30	<a href="#">&gt;&gt; 375477</a>
31	4300	MAT		yes	110	595/595/30	<a href="#">&gt;&gt; 375484</a>
36	5000	MAT			110	595/595/30	<a href="#">&gt;&gt; 375491</a>
36	5000	MAT		yes	110	595/595/30	<a href="#">&gt;&gt; 375545</a>

# CONTRA LED

GENERAL CARD

## ACCESSORIES AVAILABLE

index	Name
<a href="#">374708</a>	CONTRA LED surface-mounted frame CLICK 1200x300x65mm
<a href="#">999543</a>	Plasterboard recessing kit 630x630 white (steel version)
<a href="#">998966</a>	Frame steel white structure RAL9016 600x600 SM "well effect"
<a href="#">374715</a>	CONTRA LED surface-mounted frame CLICK 600x600x65mm
<a href="#">374845</a>	Frame adapter KG 635x635 WHITE
374852	Frame adapter KG 1235x335 WHITE
<a href="#">374692</a>	CONTRA LED suspension system 1200x300
374739	CONTRA LED - suspension system 1200x300 DALI
<a href="#">374685</a>	CONTRA LED suspension system 600x600
374722	CONTRA LED suspension system 600x600 DALI
374838	CONTRA LED MOUNTING CLIPS IN KG (4PCS)

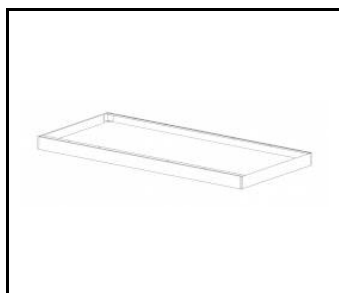

CONTRA LED surface-mounted frame CLICK 1200x300x65mm (374708)

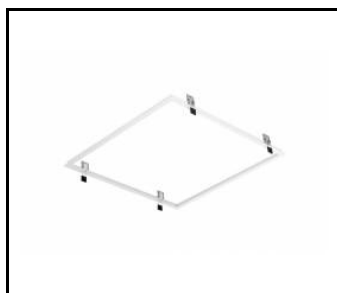

Plasterboard recessing kit 630x630 white (steel version) (999543)

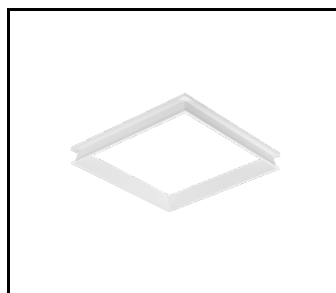

Frame steel white structure RAL9016 600x600 SM "well effect" (998966)

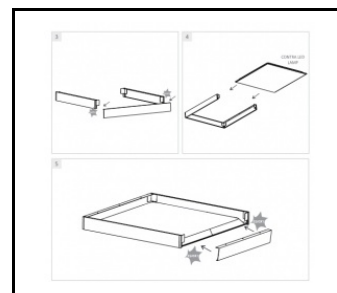

CONTRA LED surface-mounted frame CLICK 600x600x65mm (374715)



CONTRA LED suspension system 1200x300 (374692)

Card creation date: 08 January 2025

The company reserves the right to make design changes or upgrades in the presented product. Product data sheet does not constitute an offer. \* Parameter tolerance is +/- 10%

 This product is a subject to electric and electronic waste equipment regulations (WEEE).

 Certificate CE - Nr: 104/2024