

# ANELLO LED POINT 614MM 1440LM 830 60° DALI MAT WHITE (8X2,3W)

DETAILED CARD

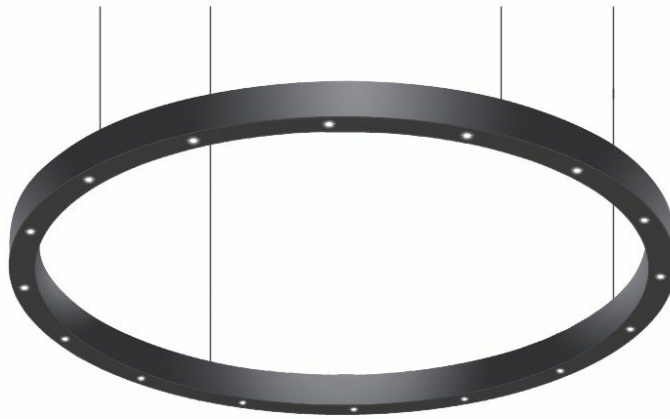

## TECHNICAL PARAMETERS

<b>Index:</b>	520594
<b>Nominal power [W]:</b>	19
<b>Luminous flux [lm]*:</b>	1440
<b>Colour temperature [K]:</b>	3000
<b>Energy efficiency class:</b>	A

## CHARACTERISTICS

Suspended LED luminaire in the shape of a circle, allowing for an interesting arrangement of large representative interiors. The luminaire is made of white powder-painted aluminum. Complete suspension system included (with central box) \*.

Available in 2 versions:

- OPAL - spreads the light evenly,
- POINT - with an innovative lens system providing a low UGR (beam angle: 30 UGR <10; 60 UGR <19), thereby reducing glare.

Available on request:

- dimensions: 1700mm, 2200mm, 3000mm, 4100mm, 5100mm, 6000mm,
- luminaire luminous flux: from 7 560 lm to 49 390 lm,
- colors: RAL 9016, RAL 1013, RAL 1036, RAL 30001, RAL 8029, RAL 8028, RAL 7024, RAL 9005,
- color temperature: 4000K,
- DALI.

\* for sizes 1135mm and 1500mm - 2 types of suspension system to choose (with central box or side box).

## APPLICATION

ANELLO LED is an extremely impressive suspended luminaire, dedicated to such interiors as lobby, reception desks, shopping malls, and showrooms. It also works well in flats, perfectly matching the elegant surroundings.

# ANELLO LED POINT 614MM 1440LM 830 60° DALI MAT WHITE (8X2,3W)

DETAILED CARD

## TECHNICAL PARAMETERS TABLE

Nominal power [W]:	19	Dimensions (H/W/T/S) [mm]:	614/85
Luminous flux [lm]:	1440	Mounting version:	suspended
Luminous efficacy [lm/W]:	76	Net weight [kg]:	6.200
Energy efficiency class:	A	CE certificate:	<a href="#">35/2020</a>
Colour temperature [K]:	3000	Index:	520594
Beam angle [°]:	60	Category of application:	architectural, HoReCa, commercial facilities, educational institutions
Diffuser type:	lens	Manual:	<a href="#">Download PDF</a>
Colour of the body:	white		

## TECHNICAL DETAILS

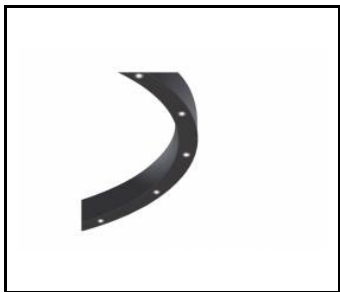

anello led 3 detal

Card creation date: 09 December 2020

The company reserves the right to make design changes or upgrades in the presented product. Product data sheet does not constitute an offer. \* Parameter tolerance is +/- 10%

 This product is a subject to electric and electronic waste equipment regulations (WEEE).

 Certificate CE - Nr: 35/2020

 **LENA**  
LIGHTING

Lena Lighting S.A.  
ul. Kórnicka 52, 63-000 Środa Wielkopolska  
tel. +48 61 28 60 333 (Pn-Pt, 8-16), e-mail: [hello@lenalighting.pl](mailto:hello@lenalighting.pl), [www.lenalighting.pl](http://www.lenalighting.pl)