

# MITRA LED 6450LM 4000K RM1 IP66 II KL. DALI (52W)

DETAILED CARD



## TECHNICAL PARAMETERS

|                                     |            |
|-------------------------------------|------------|
| <b>Light source:</b>                | LED module |
| <b>Ingress protection:</b>          | IP66       |
| <b>Nominal power [W]:</b>           | 52         |
| <b>Luminous flux [lm]*:</b>         | 6450       |
| <b>Colour temperature [K]:</b>      | 4000       |
| <b>SDCM:</b>                        | ≤ 3        |
| <b>Colour rendering index:</b>      | >80        |
| <b>Electrical protection class:</b> | II         |
| <b>Energy efficiency class:</b>     | D          |
| <b>Material of the body:</b>        | PP+FG      |

## CHARACTERISTICS

LED fitting with high luminous efficiency and an energy-saving, integrated LED panel. Body made of polypropylene (PP) with glass fiber (GF), aluminum handle and polycarbonate diffuser (PC).

The lamp is available in two versions of light distribution:

- general G1 - with a frosted diffuser,
- road RM1 - with a transparent diffuser and directional lens matrices made of PMMA.

IP66 ingress protection class and IK07 impact-rating features make this fitting shock-resistant (vandal-resistant). The integrated handle allows for top mounting to the pole. Colour of the body: gray (RAL 7010).

Standard equipped with:

- surge protection (SP10kV),
- H07RN-F cable with a length of 0.6 m and an IP66 quick connection.

## APPLICATION

Fitting used in open spaces to lighten: streets, local roads, bicycle paths, alleys, pavements, car parks and squares. Installation and mounting: post-top mounting. Mounting grip integrated with the fitting.

# MITRA LED 6450LM 4000K RM1 IP66 II KL. DALI (52W)

DETAILED CARD

## TECHNICAL PARAMETERS TABLE

|                                   |               |                                      |   |
|-----------------------------------|---------------|--------------------------------------|---|
| Index:                            | 956614        | Colour of the body:                  | grey  |
| EAN:                              | 5905963956614 | Dimensions (H/W/T/S) [mm]:           | 398/398/175   |
| Light source:                     | LED module    | Mounting dimensions [mm]:            | Ø60   |
| Nominal power [W]:                | 52            | Ingress protection:                  | IP66  |
| Rated power of the luminaire [W]: | 51.30         | Mounting version:                    | on the pole   |
| Supply voltage [V]:               | 220-240       | Working temperature [°C]:            | from -15 to +35   |
| Frequency [Hz]:                   | 50 - 60       | Diode size [mm]:                     | 2835  |
| Luminous flux [lm]:               | 6450          | Dimensions of single box [mm]:       | 400/400/175   |
| Luminous efficacy [lm/W]:         | 128           | Net weight [kg]:                     | 2.100   |
| Energy efficiency class:          | D             | Warranty [years]:                    | 5   |
| Electrical protection class:      | II            | Category type:                       | Park and city lighting  |
| Colour temperature [K]:           | 4000          | Light distribution type:             | RM1   |
| Colour rendering index:           | >80           | Category of application:             | parkings and bicycle paths  |
| SDCM:                             | ≤ 3           | DIMM 1-10V:                          | yes   |
| Power factor:                     | 0.97          | DIMM DALI:                           | yes   |
| LED lifespan L70B50 [h]:          | 90000         | Gross weight [kg]:                   | 2.100   |
| Surge protection [kV]:            | 4             | Permeability factor of the diffuser: | 0.80  |
| Diffuser material:                | PC            | ETIM class:                          | EC000062  |
| Diffuser type:                    | transparent   | Photobiological safety:              | Risk Group 1 (no photobiological hazard under normal behavioral limitation) |
| Diffuser colour:                  | transparent   | ULOR:                                | 0%  |
| Optics material:                  | PMMA          | Warranty [years]:                    | 5   |
| Optics:                           | matrix lens   | CE certificate:                      | <a href="#">38/2024</a>   |
| Material of the body:             | PP+FG         | Manual:                              | <a href="#">Download PDF</a>  |

## LIGHT CURVES

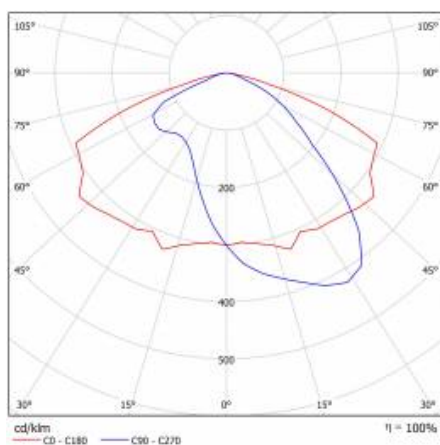

# MITRA LED 6450LM 4000K RM1 IP66 II KL. DALI (52W)

DETAILED CARD

## TECHNICAL DETAILS

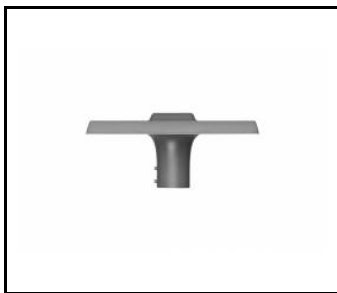

MITRA LED



MITRA LED

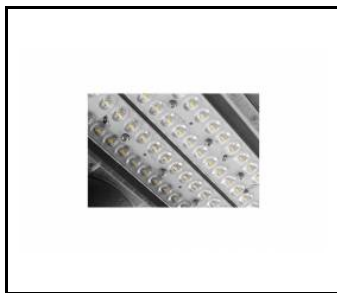

MITRA LED

Card creation date: 16 December 2021

The company reserves the right to make design changes or upgrades in the presented product. Product data sheet does not constitute an offer. \* Parameter tolerance is +/- 10%



This product is a subject to electric and electronic waste equipment regulations (WEEE).



Certificate CE - Nr: 38/2024