

MIRRA LED IP44 15W 600MM 4000K

DETAILED CARD



TECHNICAL PARAMETERS

Index:	703164
Ingress protection:	IP44
Nominal power [W]:	15
Luminous flux [lm]*:	1200
Colour temperature [K]:	4000
Colour rendering index:	>80
Electrical protection class:	II
Energy efficiency class:	F
Diffuser type:	OPAL
Mounting version:	surface, wall mounted

CHARACTERISTICS

Versatile LED luminaire intended for indoor use in rooms with increased humidity. It is widely used in office and commercial facilities, in particular, bathrooms and toilets. Body made of PC. White and grey end caps included.

APPLICATION

The luminaire is suitable for rooms that require increased ingress protection (IP44) such as toilets and bathrooms in public facilities; schools, public offices; shopping malls, office buildings and industrial buildings.

MIRRA LED IP44 15W 600MM 4000K

DETAILED CARD

TECHNICAL PARAMETERS TABLE

Nominal power [W]:	15	Colour of the body:	white
Light source:	LED module	Ingress protection:	IP44
Colour temperature [K]:	4000	Mounting version:	surface, wall mounted
Luminous flux [lm]:	1200	Working temperature [°C]:	from -10 to +35
Rated power of the luminaire [W]:	15	Net weight [kg]:	0.350
Diffuser type:	OPAL	CE certificate:	35/2018
Supply voltage [V]:	220-240	Index:	703164
Dimensions (H/W/T/S) [mm]:	52/69/600	EAN:	5905963703164
Frequency [Hz]:	50 - 60	Category type:	battens
Energy efficiency class:	F	Switch:	yes
Luminous efficacy [lm/W]:	80	ETIM class:	EC000109
Electrical protection class:	II	Photobiological safety:	Risk Group 1 (no photobiological hazard under normal behavioral limitation)
Colour rendering index:	>80	Warranty [years]:	2
Power factor:	0.50	LED lifespan L70B50 [h]:	50000
Diffuser material:	PC	LED lifespan L80B20 [h]:	32000
Diffuser colour:	white	LED lifespan L90B10 [h]:	15000
Optics material:	PC	Manual:	Download PDF
Material of the body:	PC		

LIGHT CURVES

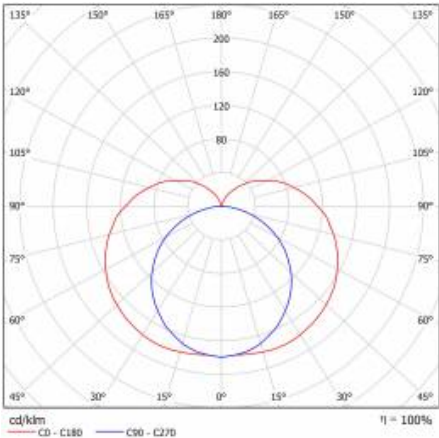

MIRRA LED IP44 15W 600MM 4000K

DETAILED CARD

TECHNICAL DETAILS



mirra led detal 1

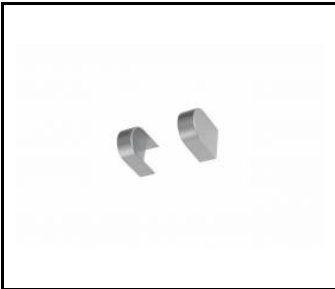

mirra led detal 2

Card creation date: 21 March 2021

The company reserves the right to make design changes or upgrades in the presented product. Product data sheet does not constitute an offer. * Parameter tolerance is +/- 10%



This product is a subject to electric and electronic waste equipment regulations (WEEE).



Certificate CE - Nr: 35/2018



Lena Lighting S.A.
ul. Kórnicka 52, 63-000 Środa Wielkopolska
tel. +48 61 28 60 333 (Pn-Pt, 8-16), e-mail: hello@lenalighting.pl, www.lenalighting.pl