

# MITRA LED 5400LM 4000K MAT IP66 II KL. DALI (44W)

DETAILED CARD



## TECHNICAL PARAMETERS

<b>Light source:</b>	LED module
<b>Ingress protection:</b>	IP66
<b>Nominal power [W]:</b>	44
<b>Luminous flux [lm]*:</b>	5400
<b>Colour temperature [K]:</b>	4000
<b>SDCM:</b>	≤ 3
<b>Colour rendering index:</b>	>80
<b>Electrical protection class:</b>	II
<b>Energy efficiency class:</b>	D
<b>Material of the body:</b>	PP+FG

## CHARACTERISTICS

LED fitting with high luminous efficiency and an energy-saving, integrated LED panel. Body made of polypropylene (PP) with glass fiber (GF), aluminum handle and polycarbonate diffuser (PC).

The lamp is available in two versions of light distribution:

- general G1 - with a frosted diffuser,
- road RM1 - with a transparent diffuser and directional lens matrices made of PMMA.

IP66 ingress protection class and IK07 impact-rating features make this fitting shock-resistant (vandal-resistant). The integrated handle allows for top mounting to the pole. Colour of the body: gray (RAL 7010).

Standard equipped with:

- surge protection (SP10kV),
- H07RN-F cable with a length of 0.6 m and an IP66 quick connection.

## APPLICATION

Fitting used in open spaces to lighten: streets, local roads, bicycle paths, alleys, pavements, car parks and squares. Installation and mounting: post-top mounting. Mounting grip integrated with the fitting.

# MITRA LED 5400LM 4000K MAT IP66 II KL. DALI (44W)

DETAILED CARD

## TECHNICAL PARAMETERS TABLE

Index:	956683	Mounting dimensions [mm]:	Ø60
EAN:	5905963956683	Ingress protection:	IP66
Light source:	LED module	Mounting version:	on the pole
Nominal power [W]:	44	Working temperature [°C]:	from -15 to +35
Rated power of the luminaire [W]:	43.70	Diode size [mm]:	2835
Supply voltage [V]:	220-240	Dimensions of single box [mm]:	400/400/175
Luminous flux [lm]:	5400	Net weight [kg]:	1.900
Luminous efficacy [lm/W]:	126	Warranty [years]:	5
Energy efficiency class:	D	Category type:	Park and city lighting
Electrical protection class:	II	Light distribution type:	G1
Colour temperature [K]:	4000	Category of application:	parkings and bicycle paths
Colour rendering index:	>80	DIMM 1-10V:	yes
SDCM:	≤ 3	DIMM DALI:	yes
Power factor:	0.98	Gross weight [kg]:	1.900
LED lifespan L70B50 [h]:	90000	Permeability factor of the diffuser:	0.80
Surge protection [kV]:	4	ETIM class:	EC000062
Diffuser material:	PC	Photobiological safety:	Risk Group 1 (no photobiological hazard under normal behavioral limitation)
Diffuser type:	frozen	ULOR:	0%
Diffuser colour:	transparent	Warranty [years]:	5
Material of the body:	PP+FG	CE certificate:	<a href="#">38/2024</a>
Colour of the body:	grey	Manual:	<a href="#">Download PDF</a>
Dimensions (H/W/T/S) [mm]:	398/398/175		

## LIGHT CURVES

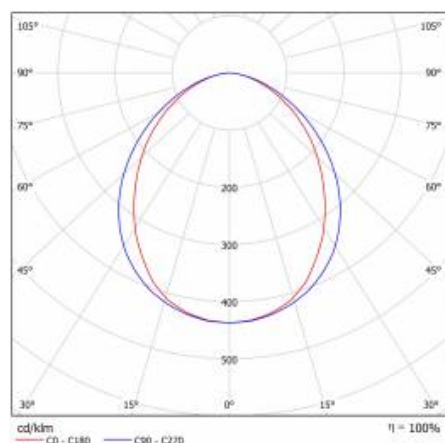

# MITRA LED 5400LM 4000K MAT IP66 II KL. DALI (44W)

DETAILED CARD

## TECHNICAL DETAILS

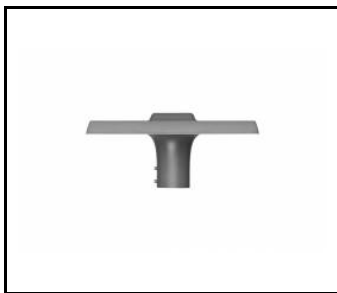

MITRA LED



MITRA LED

Card creation date: 16 December 2021

The company reserves the right to make design changes or upgrades in the presented product. Product data sheet does not constitute an offer. \* Parameter tolerance is +/- 10%



This product is a subject to electric and electronic waste equipment regulations (WEEE).



Certificate CE - Nr: 38/2024