

# CONTRA LED 595X595MM 5000LM 840 IP40/IP20 II CL. MAT PS 36W RCR

DETAILED CARD



## TECHNICAL PARAMETERS

<b>Index:</b>	761393
<b>Ingress protection:</b>	IP40/IP20
<b>Impact resistance:</b>	IK06
<b>Rated power of the luminaire [W]*:</b>	36
<b>Luminous flux [lm]*:</b>	5000
<b>Colour temperature [K]:</b>	4000
<b>Color rendering index (Ra) &gt;:</b>	80
<b>Energy efficiency class:</b>	C
<b>Electrical protection class:</b>	II
<b>Material of the body:</b>	coated aluminium

## CHARACTERISTICS

Contra LED versatile LED panel characterised by its low, slim profile and elegant design. Adapted for flush-mounted installation in modular ceilings, surface-mounted or suspended using an additional frame (available as an accessory). Luminaire with integrated energy-saving LED module, made of white painted aluminium profile, equipped with structured multi-layer PS MAT or PRM shade for perfect light diffusion.

## APPLICATION

The luminaire is intended for indoor use in office (offices, conference rooms) or representative use (hotels, restaurants); illumination of public facilities, including hospitals, educational facilities, offices, halls, garages, passageways, warehouses, shops, as well as in the food industry and food-related retail and service facilities. The unique design and excellent light performance enable CONTRA LED to be used as the main source of light, also for work that requires visual focus. The lamp is suitable for both new applications and the replacement of traditional T8 and T5 luminaires with energy-efficient LED solutions.

# CONTRA LED 595X595MM 5000LM 840 IP40/IP20 II CL. MAT PS 36W RCR

DETAILED CARD

## TECHNICAL PARAMETERS TABLE

Index:	761393	Colour of the body:	white
EAN:	5905963761393	Dimensions (H/W/T/S) [mm]:	595/595/30
Light source:	LED	Impact resistance:	IK06
Rated power of the luminaire [W]:	36	Ingress protection:	IP40/IP20
Supply voltage [V]:	220-240	Mounting version:	podtynkowy, natynkowy, zwieszany
Frequency [Hz]:	50-60	Working temperature [°C]:	from 0 to +35
Luminous flux [lm]:	5000	Number on the palette [pcs]:	50
Luminous efficacy [lm/W]:	139	Net weight [kg]:	1.060
Energy efficiency class:	C	Category type:	troffers
Electrical protection class:	II	LED lifespan L70B50 [h]:	228000
Colour temperature [K]:	4000	LED lifespan L80B20 [h]:	143000
Color rendering index (Ra) >:	80	LED lifespan L90B10 [h]:	68000
SDCM:	2	Light distribution type:	lamertian
Beam angle [°]:	110	Motion sensor:	yes
Surge protection [kV]:	1	Additional accessories:	ramka natynkowa, system zwieszania
Diffuser material:	PS	Photobiological safety:	RG0 - exempt (no photobiological hazard)
Diffuser type:	matt	Warranty [years]:	5
Diffuser colour:	milky	CE certificate:	<a href="#">26/2025</a>
Optics material:	PMMA	PZH certificate:	<a href="#">B-BK-60112-0081/2024</a>
Optics:	lens	Manual:	<a href="#">Download PDF</a>
Material of the body:	coated aluminium		

# CONTRA LED 595X595MM 5000LM 840 IP40/IP20 II CL. MAT PS 36W RCR

DETAILED CARD

## ACCESSORIES AVAILABLE

index	Name
999543	Plasterboard recessing kit 630x630 white (steel version)
374715	CONTRA LED surface-mounted frame CLICK 600x600x65mm
374708	CONTRA LED surface-mounted frame CLICK 1200x300x65mm
374692	CONTRA LED suspension system 1200x300
374685	CONTRA LED suspension system 600x600
374838	CONTRA LED MOUNTING CLIPS IN KG (4PCS)
374845	Frame adapter KG 635x635 WHITE
374852	Frame adapter KG 1235x335 WHITE
998966	Frame steel white structure RAL9016 600x600 SM "well effect"
374722	CONTRA LED suspension system 600x600 DALI
374739	CONTRA LED - suspension system 1200x300 DALI
761294	Emergency module 2W/10-50V Li-ION EMG-A-Li-2L 3h 3.6V 2.5Ah AT - CONTRA (GKO)



Plasterboard recessing kit 630x630 white (steel version) (999543)

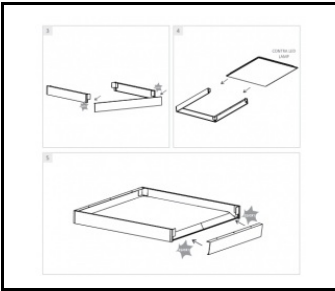

CONTRA LED surface-mounted frame CLICK 600x600x65mm (374715)

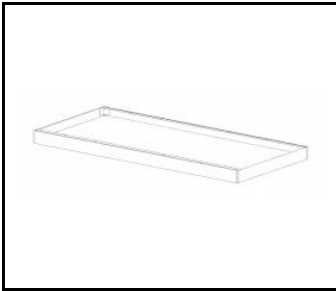

CONTRA LED surface-mounted frame CLICK 1200x300x65mm (374708)

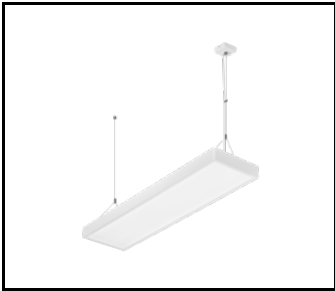

CONTRA LED suspension system 1200x300 (374692)

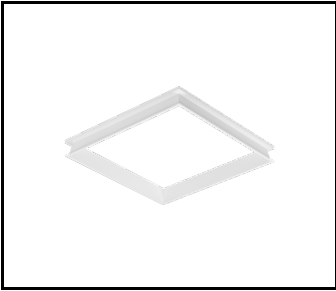

Frame steel white structure RAL9016 600x600 SM "well effect" (998966)

Card creation date:15 October 2025

The company reserves the right to make design changes or upgrades in the presented product. Product data sheet does not constitute an offer. \* Parameter tolerance is +/- 10%

 This product is a subject to electric and electronic waste equipment regulations (WEEE).

 Certificate CE - Nr: 26/2025