

# CONTRA LED SURFACE-MOUNTED FRAME CLICK 600X600X65MM

KARTA AKCESORIUM

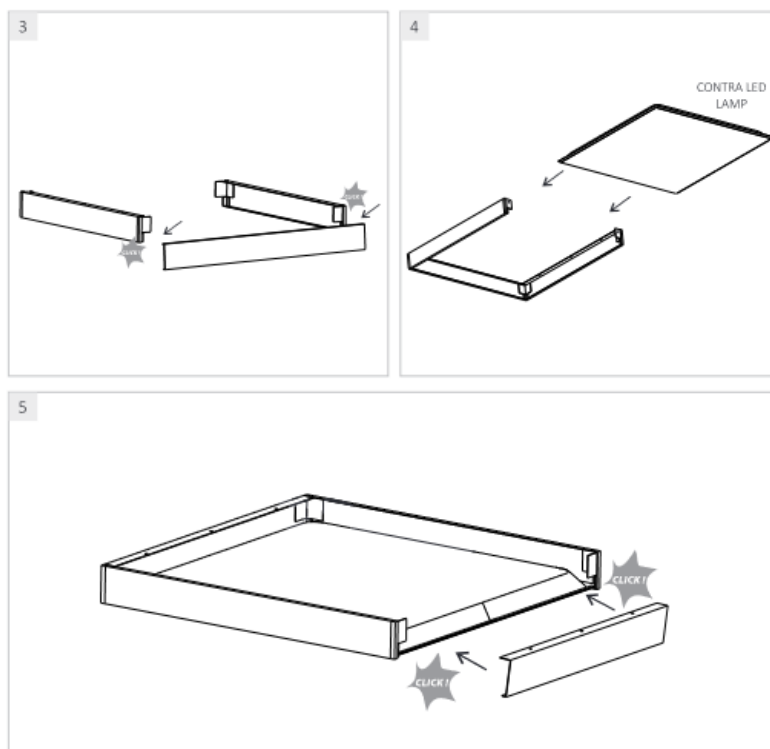

## TECHNICAL PARAMETERS

Index: 374715

## CHARACTERISTICS

Frame for surface mounting of LED panels 595x595mm.

## APPLICATION

The frame allows surface mounting of all LED panels with dimensions of 595x595mm. The frame can be used for both SLIM type LED panels (EDGE-LIT i.e. PLANO) and BACK-LIT type LED panels (i.e. CONTRA).

It consists of four aluminium profiles which, when assembled, allow the LED panel, power supply and cabling to be placed in it.

A set of screws is included to assemble the frame.

Card creation date: 10 July 2024

The company reserves the right to make design changes or upgrades in the presented product. Product data sheet does not constitute an offer. \* Parameter tolerance is +/- 10%



This product is a subject to electric and electronic waste equipment regulations (WEEE).



Certificate CE - Nr: