

MIRRA LED IP44 15W 600MM 4000K

DETAILED CARD



TECHNICAL PARAMETERS

| | |
|------------------------------|-----------------------|
| Index: | 703164 |
| Ingress protection: | IP44 |
| Nominal power [W]: | 15 |
| Luminous flux [lm]*: | 1200 |
| Colour temperature [K]: | 4000 |
| Colour rendering index: | >80 |
| Electrical protection class: | II |
| Energy efficiency class: | F |
| Diffuser type: | OPAL |
| Mounting version: | surface, wall mounted |

CHARACTERISTICS

Versatile LED luminaire intended for indoor use in rooms with increased humidity. It is widely used in office and commercial facilities, in particular, bathrooms and toilets. Body made of PC. White and grey end caps included.

APPLICATION

The luminaire is suitable for rooms that require increased ingress protection (IP44) such as toilets and bathrooms in public facilities; schools, public offices; shopping malls, office buildings and industrial buildings.

MIRRA LED IP44 15W 600MM 4000K

DETAILED CARD

TECHNICAL PARAMETERS TABLE

| | | | |
|-----------------------------------|------------|----------------------------|---|
| Light source: | LED module | Dimensions (H/W/T/S) [mm]: | 52/69/600 |
| Nominal power [W]: | 15 | Ingress protection: | IP44 |
| Rated power of the luminaire [W]: | 15 | Mounting version: | surface, wall mounted |
| Supply voltage [V]: | 220-240 | Working temperature [°C]: | from -10 to +35 |
| Frequency [Hz]: | 50 - 60 | Net weight [kg]: | 0.350 |
| Luminous flux [lm]: | 1200 | CE certificate: | 35/2018 |
| Luminous efficacy [lm/W]: | 80 | Index: | 703164 |
| Energy efficiency class: | F | EAN: | 5905963703164 |
| Electrical protection class: | II | Category type: | battens |
| Colour temperature [K]: | 4000 | Switch: | yes |
| Colour rendering index: | >80 | ETIM class: | EC000109 |
| Power factor: | 0.50 | Photobiological safety: | Risk Group 1 (no photobiological hazard under normal behavioral limitation) |
| Diffuser material: | PC | Warranty [years]: | 2 |
| Diffuser type: | OPAL | LED lifespan L70B50 [h]: | 50000 |
| Diffuser colour: | white | LED lifespan L80B20 [h]: | 32000 |
| Optics material: | PC | LED lifespan L90B10 [h]: | 15000 |
| Material of the body: | PC | Manual: | Download PDF |
| Colour of the body: | white | | |

LIGHT CURVES

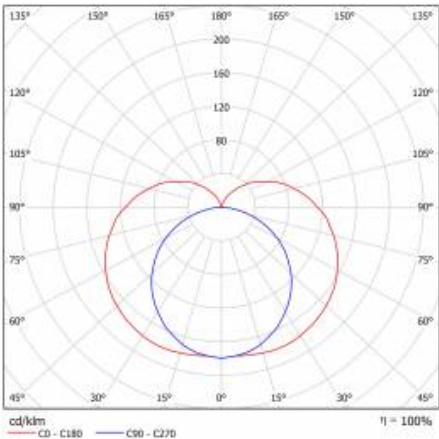

MIRRA LED IP44 15W 600MM 4000K

DETAILED CARD

TECHNICAL DETAILS



mirra led detal 1

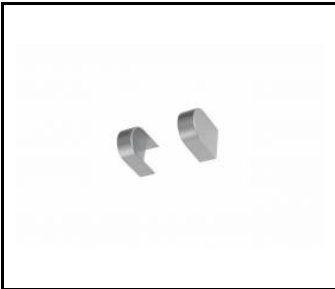

mirra led detal 2

Card creation date: 21 March 2021

The company reserves the right to make design changes or upgrades in the presented product. Product data sheet does not constitute an offer. * Parameter tolerance is +/- 10%



This product is a subject to electric and electronic waste equipment regulations (WEEE).



Certificate CE - Nr: 35/2018



Lena Lighting S.A.
ul. Kórnicka 52, 63-000 Środa Wielkopolska
tel. +48 61 28 60 333 (Pn-Pt, 8-16), e-mail: hello@lenalighting.pl, www.lenalighting.pl